

TRAFFIC UPDATE - Airport

Week of April 1, 2018

KAMEHAMEHA HIGHWAY – PEARL HARBOR AREA

Sunday, April 1, 2018 to Saturday, April 7, 2018

LOCATION: Ford Island Bridge/Salt Lake Boulevard to Kohomua Street

Daytime: 6:30 a.m. to 2:30 p.m., Monday to Friday

Alternating lanes of westbound Kamehameha Highway will be closed.

Daytime: 8:30 a.m. to 5:00 p.m., Monday to Friday

Alternating lanes of eastbound Kamehameha Highway will be closed.

Nighttime: 6:00 p.m. to 5:00 a.m., overnights Monday to Friday

Alternating lanes of eastbound Kamehameha Highway will be closed.

Nighttime: 8:00 p.m. to 5:00 a.m., overnights Monday to Friday

Alternating lanes of westbound Kamehameha Highway will be closed.

LOCATION: Kohomua Street to Arizona Memorial Place/Kalaloa Street

24 Hours a Day, Seven Days a Week

The inside lanes of eastbound Kamehameha Highway will be closed.

Daytime: 6:30 a.m. to 2:30 p.m., Monday to Friday

Alternating lanes of westbound Kamehameha Highway will be closed.

Daytime: 8:30 a.m. to 5:00 p.m., Monday to Friday

Alternating lanes of eastbound Kamehameha Highway will be closed.

Nighttime: 6:00 p.m. to 5:00 a.m., overnights Monday to Friday

Alternating lanes of eastbound Kamehameha Highway will be closed.

Nighttime: 8:00 p.m. to 5:00 a.m., overnights Monday to Friday

Alternating lanes of westbound Kamehameha Highway will be closed.

LOCATION: Kalaloa Street Intersection

Nighttime: 8:00 p.m. to 5:00 a.m., overnights Monday to Friday

The right-turn from westbound Kamehameha Highway onto Kalaloa Street will be closed.

Motorists will be detoured to a u-turn at Salt Lake Boulevard.



LOCATION: Arizona Memorial Place Intersection

Nighttime: 6:00 p.m. to 5:00 a.m., overnights Monday to Friday

The left-turn from westbound Kamehameha Highway onto Arizona Memorial Place will be closed. Motorists will be detoured to a u-turn at Salt Lake Boulevard.

Nighttime: 6:00 p.m. to 5:00 a.m., overnights Monday to Friday

The left-turn from Arizona Memorial Place onto westbound Kamehameha Highway will be closed. Motorists will be detoured to a u-turn at Halawa Drive.

LOCATION: Arizona Memorial Place/Kalaloa Street to Halawa Drive/Arizona Street

24 Hours a Day, Seven Days a Week

The inside lanes of eastbound Kamehameha Highway will be closed.

Daytime: 6:30 a.m. to 2:30 p.m., Monday to Friday

Alternating lanes of westbound Kamehameha Highway will be closed.

Daytime: 8:30 a.m. to 5:00 p.m., Monday to Friday

Alternating lanes of eastbound Kamehameha Highway will be closed.

Nighttime: 6:00 p.m. to 5:00 a.m., overnights Monday to Friday

Alternating lanes of eastbound Kamehameha Highway will be closed.

Nighttime: 8:00 p.m. to 5:00 a.m., overnights Monday to Friday

Alternating lanes of westbound Kamehameha Highway will be closed.

LOCATION: Halawa Drive Intersection (Borchers Gate)

Nighttime: 6:00 p.m. to 5:00 a.m., overnights Monday to Friday

The left-turn from eastbound Kamehameha Highway onto Halawa Drive will be intermittently closed. Motorists will be detoured to a u-turn at Arizona Street.

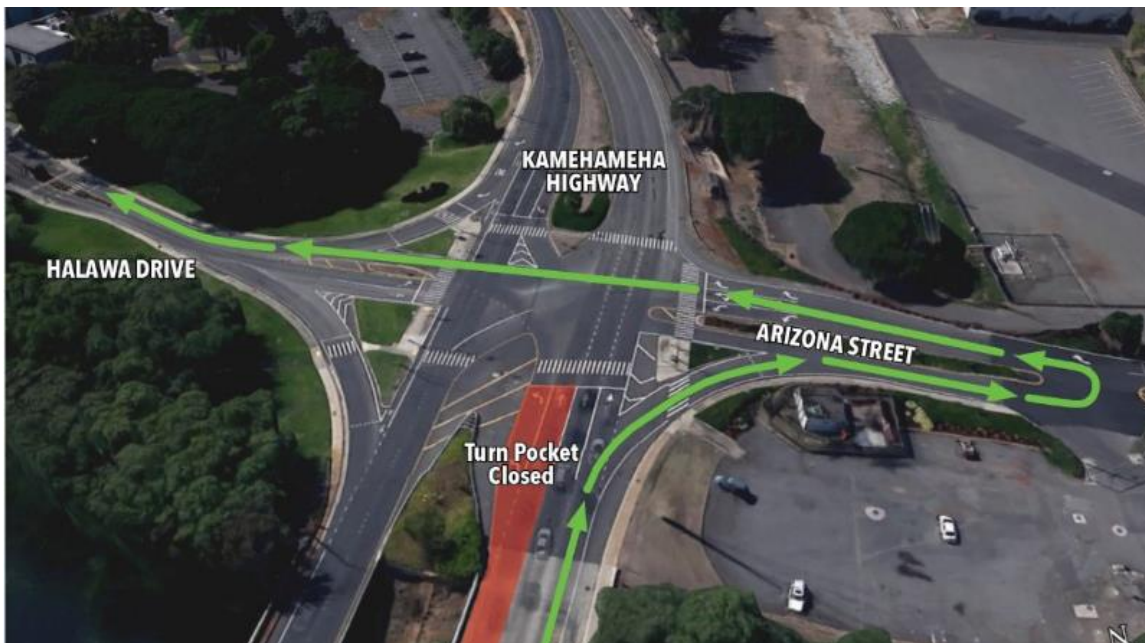

Nighttime: 6:00 p.m. to 5:00 a.m., overnights Monday to Friday

The left-turn from Halawa Drive onto eastbound Kamehameha Highway will be intermittently closed. Motorists will be detoured to a u-turn at Arizona Memorial Place.

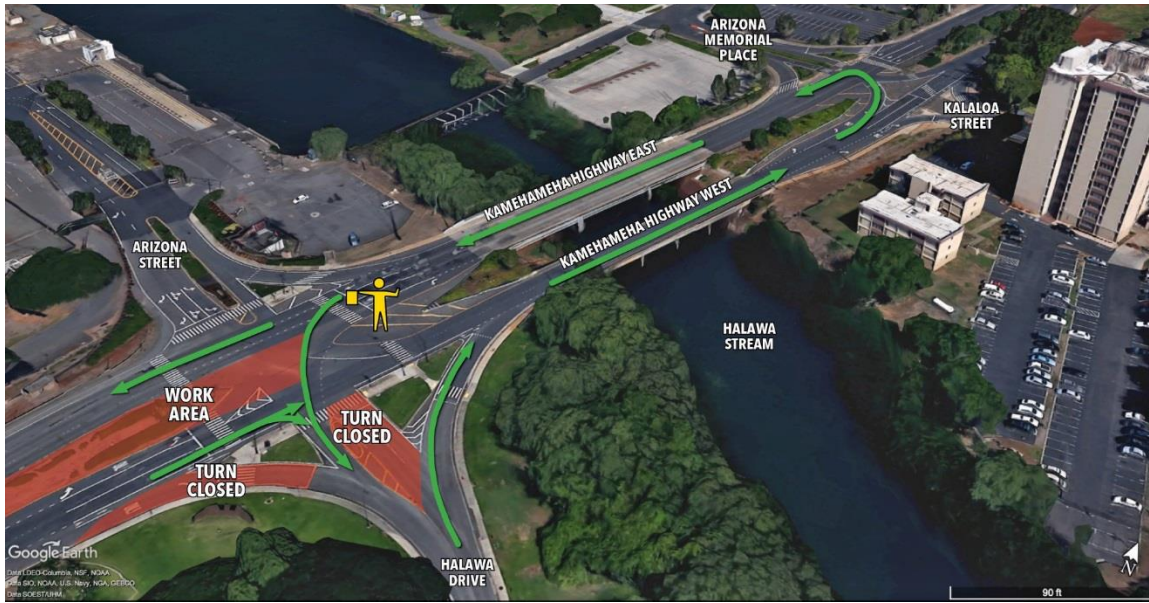

LOCATION: Arizona Drive Intersection (Halawa Gate)

Nighttime: 6:00 p.m. to 5:00 a.m., overnights Monday to Friday

The left-turn from westbound Kamehameha Highway onto Arizona Street will be closed. Motorists will be detoured to a u-turn at Arizona Memorial Place.

LOCATION: Halawa Drive/Arizona Street to Radford Drive/Makalapa Road

24 Hours a Day, Seven Days a Week

The inside lanes of eastbound Kamehameha Highway will be closed.

Daytime: 6:30 a.m. to 2:30 p.m., Monday to Friday

Alternating lanes of westbound Kamehameha Highway will be closed.

Daytime: 8:30 a.m. to 5:00 p.m., Monday to Friday

Alternating lanes of eastbound Kamehameha Highway will be closed.

Nighttime: 6:00 p.m. to 5:00 a.m., overnights Monday to Friday

Alternating lanes of eastbound Kamehameha Highway will be closed.

Nighttime: 8:00 p.m. to 5:00 a.m., overnights Monday to Friday

Alternating lanes of westbound Kamehameha Highway will be closed.

Nighttime: 8:00 p.m. to 4:00 a.m., overnight Wednesday

The lanes of westbound Kamehameha Highway will be intermittently closed and redirected to the eastbound lanes. Special duty officers and flaggers will be onsite to assist. Bus stops will be relocated as necessary. Pedestrian access will be maintained.

LOCATION: Radford Drive Intersection

Nighttime: 6:00 p.m. to 5:00 a.m., overnights Monday to Friday

The left-turn from eastbound Kamehameha Highway onto Radford Drive will be closed. Motorists will be detoured to u-turn at Valkenburgh Street.

Nighttime: 6:00 p.m. to 5:00 a.m., overnights Monday to Friday

The left-turn from Radford Drive onto eastbound Kamehameha Highway will be closed. Motorists will be detoured to a u-turn at Arizona Street.

LOCATION: Makalapa Road Intersection (Makalapa Gate)

Nighttime: 10:00 p.m. to 5:00 a.m., overnights Monday to Friday

The left-turn from Makalapa Road onto westbound Kamehameha Highway will be closed. Motorists will be detoured to u-turn at Valkenburgh Street.

LOCATION: Radford Drive/Makalapa Road to Plantation Drive/Center Drive

24 Hours a Day, Seven Days a Week

The inside lanes of eastbound Kamehameha Highway will be closed.

Daytime: 6:30 a.m. to 2:30 p.m., Monday to Friday

Alternating lanes of westbound Kamehameha Highway will be closed.

Daytime: 8:30 a.m. to 5:00 p.m., Monday to Friday

Alternating lanes of eastbound Kamehameha Highway will be closed.

Nighttime: 6:00 p.m. to 5:00 a.m., overnights Monday to Friday

Alternating lanes of eastbound Kamehameha Highway will be closed.

Nighttime: 8:00 p.m. to 5:00 a.m., overnights Monday to Friday

Alternating lanes of westbound Kamehameha Highway will be closed.

For the safety of crews and the traveling public, the speed limit has been reduced to 25 mph on Kamehameha Highway between Salt Lake Boulevard/ Ford Island Bridge and Center Drive. The highway has been reduced to two lanes in each direction during construction. Bike lanes have been removed due to space constraints. Please drive safely; observe the posted speed limit, follow construction and directional signs, and share the road with bicyclists.

Bus routes and stops may be modified or closed during construction. Please call (808) 848-5555 or visit www.TheBus.org.

PEARL HARBOR INTERCHANGE

Sunday, April 1, 2018 to Saturday, April 7, 2018

LOCATION: Kamehameha Highway to Nimitz Highway

24 Hours a Day, Seven Days a Week

The eastbound ramp from Kamehameha Highway onto eastbound Nimitz Highway will be reduced to one lane.

Nighttime: 8:00 p.m. to 4:00 a.m., overnights Tuesday through Thursday

The eastbound ramp from Kamehameha Highway onto eastbound Nimitz Highway will be closed.

Motorists will be detoured to Nimitz Highway.

Nighttime: 8:00 p.m. to 4:00 a.m., overnight Wednesday

Various interchange ramps will be intermittently closed. Detour signs will be posted for alternative routes.

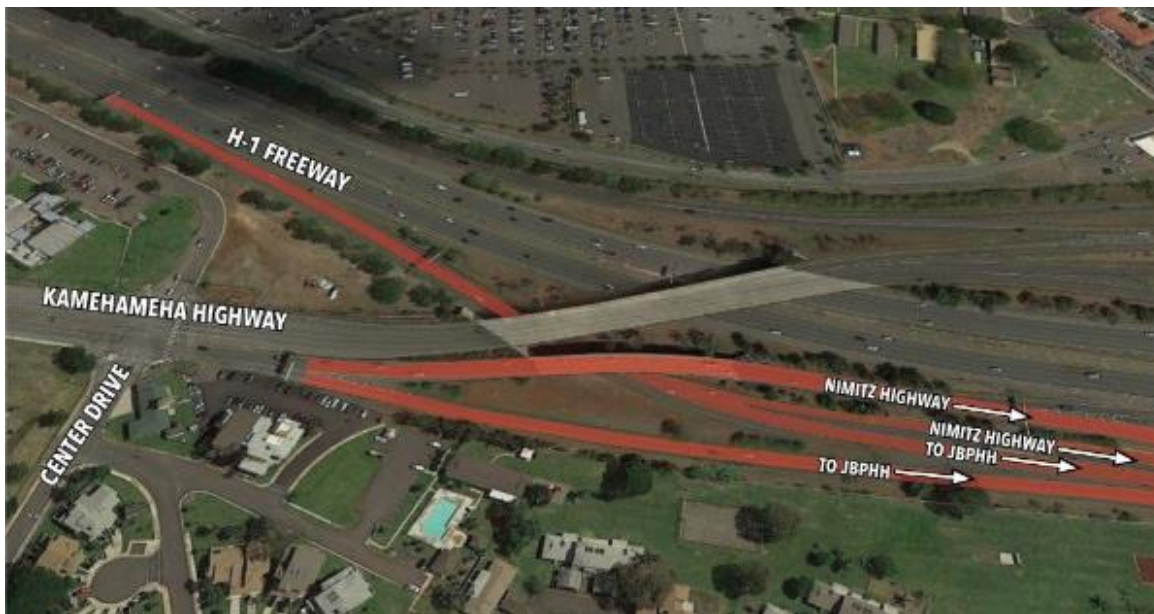

LOCATION: H-1 On-Ramp from Joint-Base Pearl Harbor-Hickam

24 Hours a Day, Seven Days a Week

The ramp from Joint-Base Pearl Harbor-Hickam onto eastbound H-1 will be reduced to one lane.

Nighttime: 8:00 p.m. to 4:00 a.m., overnights Tuesday through Thursday

The eastbound ramp from Joint-Base Pearl Harbor-Hickam onto eastbound H-1 will be closed.

Motorists will be detoured to Nimitz Highway.

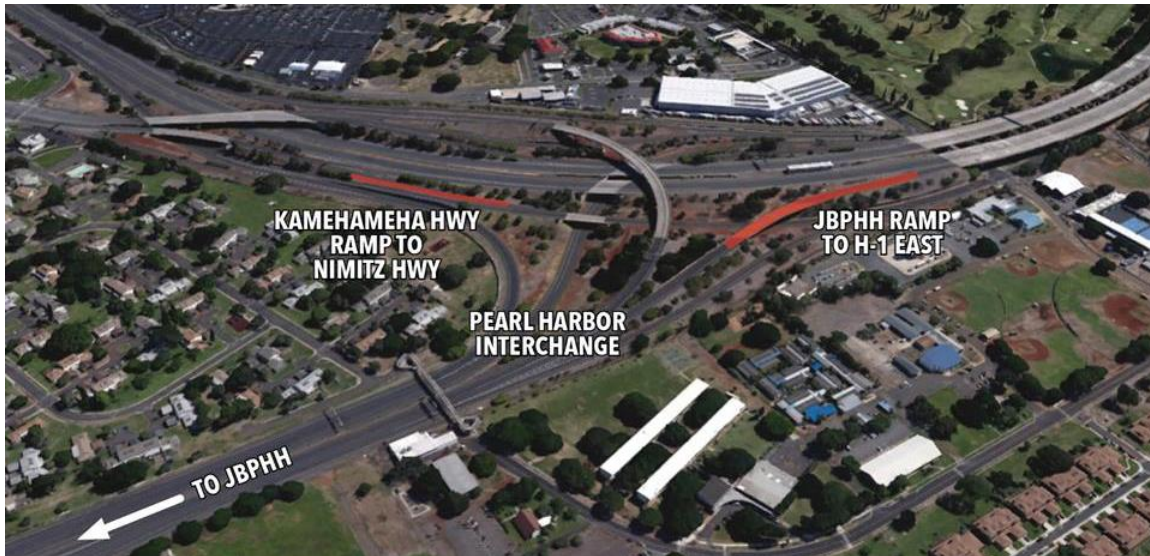

NIMITZ

Sunday, April 1, 2018 to Saturday, April 7, 2018

LOCATION: Pearl Harbor Interchange to Main Street

24 Hours a Day, Seven Days a Week

The outside lane of eastbound Kamehameha Highway will be closed.

Daytime: 8:30 a.m. to 3:00 p.m., Monday to Friday

One lane of eastbound Nimitz Highway will be closed.

Nighttime: 8:00 p.m. to 4:00 a.m., overnights Sunday to Friday

One lane of eastbound Nimitz Highway will be closed.



Work may include intermittent lane closures at the Valkenburgh Street intersection, including various left-turn and right-turn pockets. Special-duty officers will assist with traffic movements as needed. Bus stops will be relocated during construction. Pedestrians will be detoured around the construction area.

LOCATION: Main Street to Aolele Street

Daytime: 8:30 a.m. to 3:00 p.m., Monday to Friday

Up to two lanes of eastbound Nimitz Highway will be closed.

Nighttime: 8:00 p.m. to 5:00 a.m., overnights Monday to Friday

Up to two lanes of eastbound Nimitz Highway will be closed.

AIRPORT

Sunday, April 1, 2018 to Saturday, April 7, 2018

LOCATION: Ala Onaona Street between Aolele Street to Lei Stands Entrance

Nighttime: 10:00 p.m. to 4:00 a.m., overnights Monday to Friday

Roadway may be closed for work. Local traffic will be maintained via flaggers and onsite personnel.

LOCATION: Ala Auana Street between Ala Onaona Street to Rodgers Boulevard

Nighttime: 10:00 p.m. to 4:00 a.m., overnights Monday to Friday

Roadway may be closed.

LOCATION: Airport Parking Garages at Toll Booth Road

Nighttime: 10:00 p.m. to 4:00 a.m., overnights Monday to Friday

Up to two lanes may be closed.

LOCATION: Ala Onaona Street/Aolele Street between Airport Parking Garage Exit to H-1 On-Ramp

Nighttime: 10:00 p.m. to 4:00 a.m., overnights Monday to Friday

Aolele Street eastbound access from Ala Onaona Street may be closed. Motorists will be detoured to westbound Aolele Street and Nimitz Highway. Access to H-1 will remain open.

LOCATION: Aolele Street at Paiea Street Intersection

Nighttime: 10:00 p.m. to 4:00 a.m., overnights Monday to Friday

Intersection will be intermittently closed. Turning movements may be restricted. Special Duty Officers will assist with traffic as needed.

LOCATION: Aolele Street between Paiea Street and Lagoon Drive

Nighttime: 10:00 p.m. to 4:00 a.m., overnights Monday to Friday

One lane will be closed. On-site flaggers will be controlling traffic bi-directional in remaining lane.

Nighttime: 10:00 p.m. to 4:00 a.m., overnights Monday to Friday

The westbound H-1 On-Ramp may be closed.

KALIHI

Sunday, April 1, 2018 to Saturday, April 7, 2018

LOCATION: Kamehameha Highway between Middle Street and Puuhale Road

Nighttime: 8:00 p.m. to 5:00 a.m., overnights Monday to Friday

Up to two lanes will be closed on eastbound and westbound Kamehameha Highway. Work will include intermittent closures near the Middle Street intersection. Various left-turn and right-turn pockets may be closed. Highway ramps may also be affected. Special Duty Officers will be on-site to assist with traffic movements. Bike lanes, bus stops and sidewalks may be impacted by the work.